

Sapphire[®]

DECORATIVE FANS . SINCE 1993

Instruction Manual

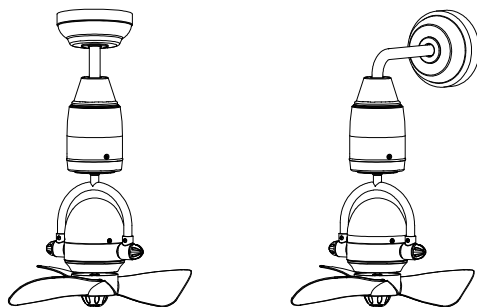
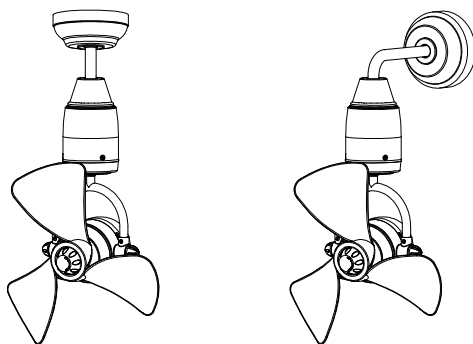

MODEL: FM-768S-DC

CEILING FAN

IMPORTANT SAFETY INSTRUCTIONS

IMPORTANT: PLEASE READ BEFORE INSTALLATION

- Installation must be carried out by a qualified wiring installer.
- Turn off the electrical mains at the circuit breaker fuse box.
- Use power supply 220-240V/50Hz.
- The ceiling mounting must be able to hold a min of 16kg.
- Install ceiling fan blade more than 2.3M above floor.
- Do not place any object in the path of the blades.
- When all electrical connection is done, store all wire neatly.
- Make sure that all screws and connection are tightly screwed and secured.
- This appliances is not intended for use by persons (including children) with reduced physical, sensory or mental capabilities, or lack of experience and knowledge, unless they have been given supervision or instruction concerning use of the appliances by a person responsible for their safety. Children should be supervised to ensure that they do not play with the appliances.
- Children without supervision shall not proceed with maintainance, cleaning or play with the appliance.
- Pole disconnection must be incorporated in the fixed wiring in accordance with the wiring rule, pole disconnection must be incorporated in the fixed wiring is to be provided.

TROUBLESHOOTING

Check on the following before lodging a service report.

Problem	Cause of Issue	Solution
Fan not moving	<ul style="list-style-type: none">• Main cables not connected• Wire connection loose	<ul style="list-style-type: none">• Check main and branch circuit breakers or fuse.• Check the line wires connections to the fan and switch.
Fan noisy	<ul style="list-style-type: none">• Housing screws are loose• Wire and nut connections rattles against each other.• Canopy touches the ceiling.t	<ul style="list-style-type: none">• Tighten all screws• Separate and store neatly the wire connections from the nut.• Check to ensure the canopy is not touching or too close to the
Remote control Not working	<ul style="list-style-type: none">• Remote and receiver code different• Battery not installed• Weak battery	<ul style="list-style-type: none">• Check that the codes to ensure• Battery not installed exactly the same.• Weak battery• Install the remote control battery

INTRODUCTION OF PARTS

(1) Downrod(Ceiling Mount)

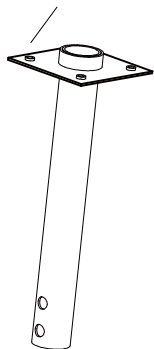

(2) Downrod(WallMount)

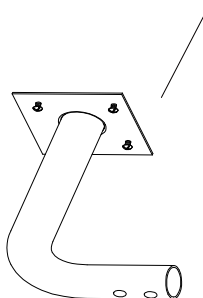

(3) Upper Canopy

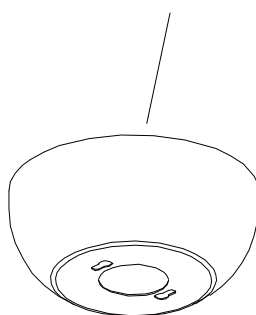

(4) Bracket Mount

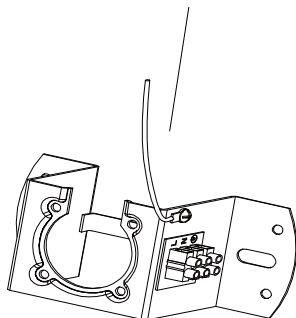

(5) Receiver

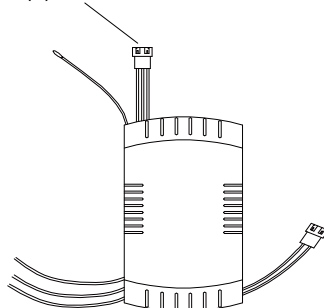

(6) Remote

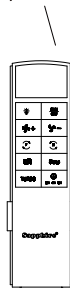

(7) Down Canopy

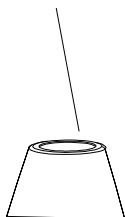

(8) Main Body

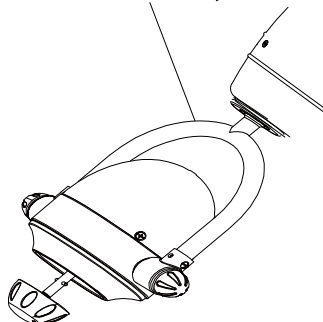

(9) Blade

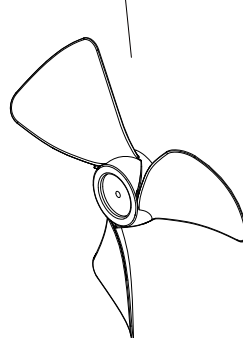

(10) Bolt(2)

(11)Fixed Buckle

(12)Canopy Cover

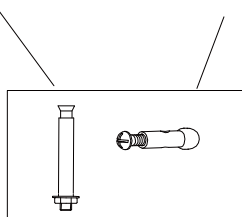

CONTROLS AND OPERATIONS

FAN INSTALLATION INSTRUCTION

- The fan must be installed so that the lowest point of the fan blade must be 2.3m from the floor.

NOTE: The lowest point of the fan blade is when the fan head is adjusted to 45°.

- The ceiling fan must be installed in a location that the blades has a minimum 1M spacing from the tip of the blade to the nearest objects or walls.

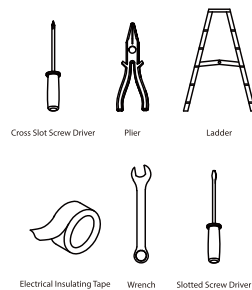
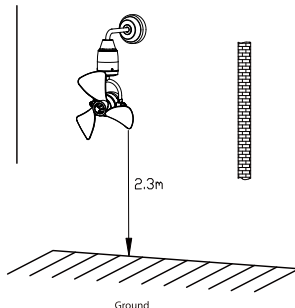
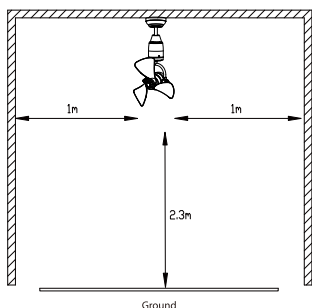

Wiring Diagram

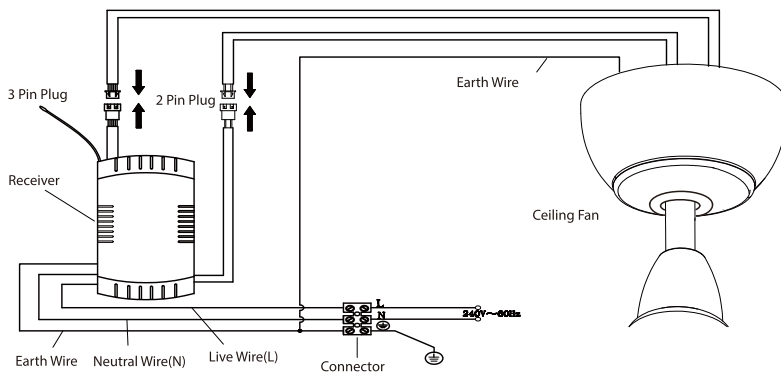

Installation Steps

- Steps 1 Install bracket mount on ceiling
- 1-B: Install bracket mount on wall

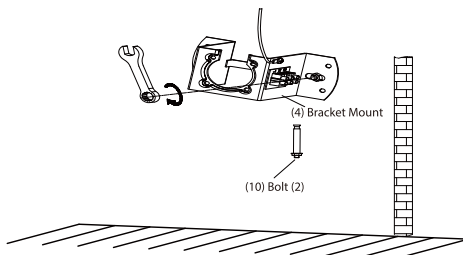
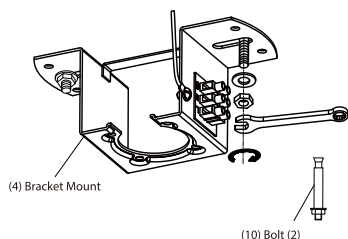

- Steps 2 Install downrod onto main body
- 2-A: Remove bolt from the main body

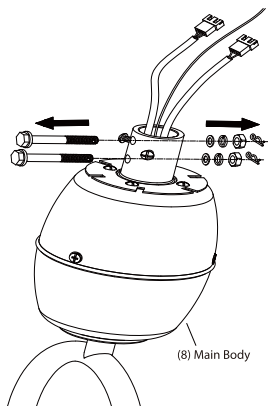

- 2-B: Insert rubber ring and motor hood onto downrod

(2) Downrod(Wall Mount)

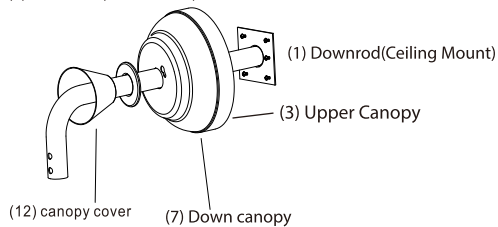

Wall Mounted Method Diagram 1

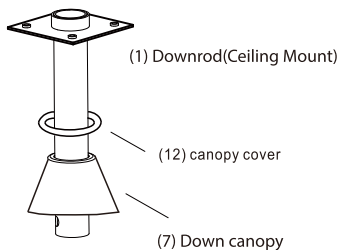

Ceiling Mounted Method Diagram 1

- 2-B: Pass the wires and safety cable from the main body through the downrod and screw the downrod onto the main body.

(Diagram 4 for wall mount, Diagram 5 for ceiling mount)

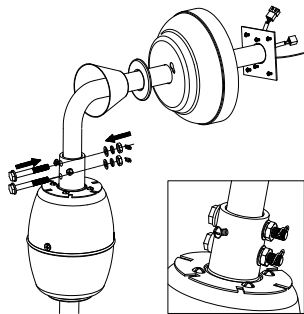

(Diagram 4)

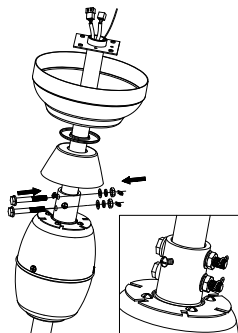

(Diagram 5)

- Tighten the 2 screws so that the downrod is not loose, and move the motor canopy down to the bottom. (Diagram 6)

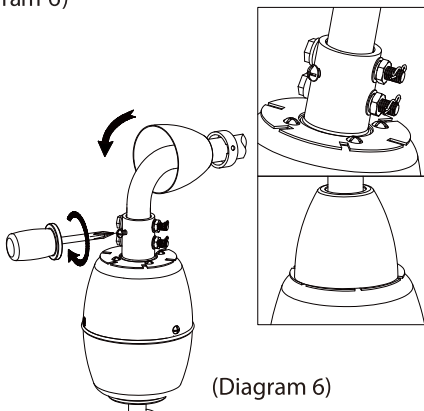

(Diagram 6)

Steps 3 : Wall Mount Assembly

- 3-A : Unscrew 4 screw from the downrod (wall mount)(Diagram 7).
Hang the wall mount onto the Bracket Mount and screw in the 4 screws. (Diagram 8)

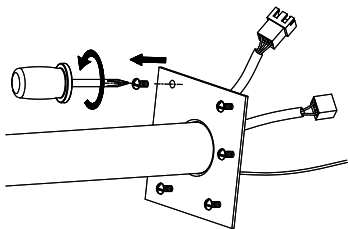

(Diagram 7)

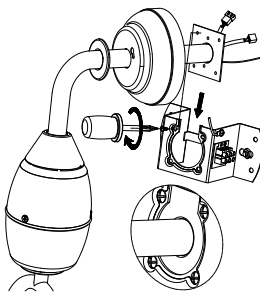

(Diagram 8)

- 3-B: Unscrew 4 screw from the downrod (ceiling mount) (Diagram 9)
Hang the ceiling mount onto the bracket mount and screw in the 4 screw. (Diagram 10)

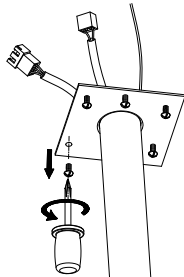

(Diagram 9)

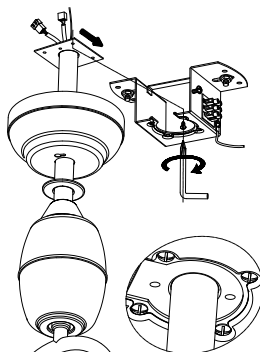

(Diagram 10)

Steps 4: Safety Cable Installation (For ceiling mount)

- 4-A: Make a knot at the end of the cable and secure it with the fixed buckle. (Diagram 11)
- 4-B: Put the safety cable fixed on the bracket. (Diagram 12)

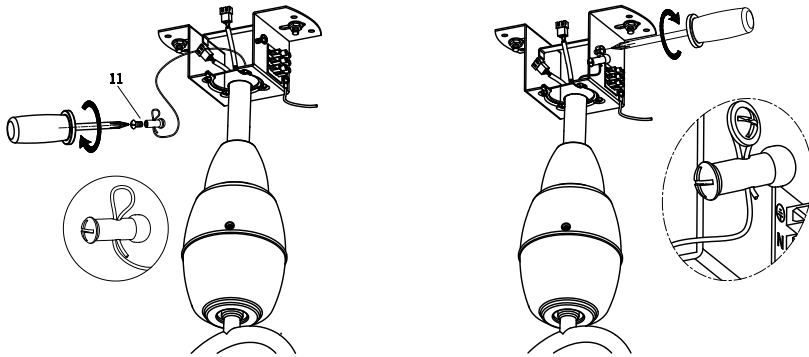

Steps 5: Upper Canopy Installation Method

- 5-1: Ceiling Mount Installation Method (Diagram 13)

a: Arrange wires and place it in the receiver into the bracket.

b: Attach the canopy to the ceiling and push up the rubber ring to block the canopy and screw the rubber ring.

- 5-2: Wall Mount Installation Method (Diagram 14)

a: Tuck all the connections neatly into the outlet box.

b: Slide the canopy up to the ceiling mounting bracket and place the key hole slots over the mounting screws or bolts on the bracket. Rotate the canopy until the screw or bolt

c: heads lock in place at the narrow section of the key hole.

Attach the canopy cover to the bottom of the canopy and screw it into place.

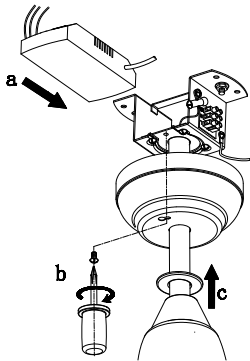

(Diagram 13)

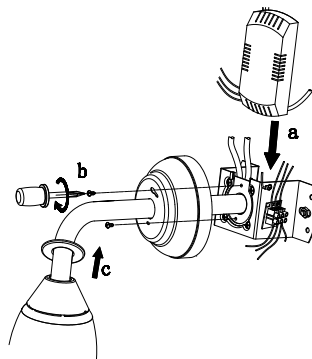

(Diagram 14)

Steps 6: Blade Installation

- 6-A: Remove the front knob and metal nut in clockwise direction. (Diagram 15)
 - 6-B: Slot in the blade into the metal shaft
(Cross pin on the shaft should be placed into the blade groove) (Diagram 16)
- Screw back both metal nut and front knob back to the shaft in anticlockwise direction.
(Diagram 17)

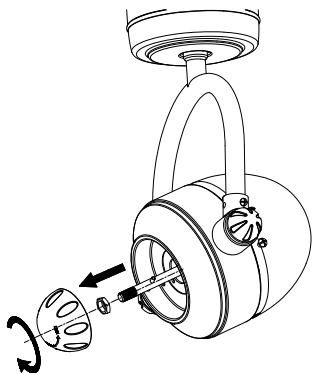

(Diagram 15)

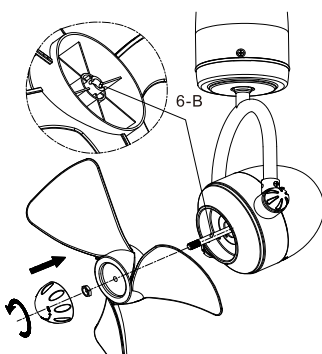

(Diagram 16)

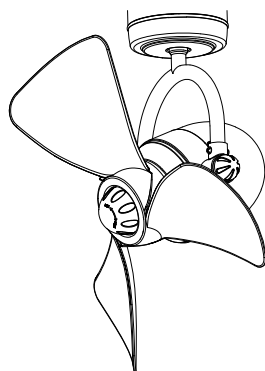

(Diagram 17)

CLEANING AND MAINTENANCE

Due to fan's natural movement, connections may get loose after a period of usage. To ensure a proper and safety usage, we highly recommended user inspect and tighten all connections every 6 months.

CLEANING

- Clean your fan periodically to prolong its new appearance. Basic cleaning procedures are as follows:
- Use only lukewarm water. Do not use detergent, corrosive or acidic solution.
- Damp the cloth lightly. Use only soft or lint-free cloth to clean the fan. Rough fabric will scratches the surface.
- To cover small scratches, apply a light coat of shoe polish over it.
- There is no need to lubricant the fan.